

Setting for Fujifilm X20

This product is designed exclusively for use with Fujifilm X10 and X20 digital camera and is not compatible for other cameras. Certain function buttons on the MDX-X10 housing are labelled differently from the X20 camera. A set of replacement stickers is included in your MDX-X10 housing to replace these respectively buttons shown on the diagram. All the other functions on the camera are similar. Kindly refer to your X20 camera instruction manual for details.

Note : OVF/LCD SETTING on the Fujifilm X20 camera must be set to **LCD** for use as no image will appear if set on OVF or EYE SENSOR.

Part Names use with Fujifilm X20

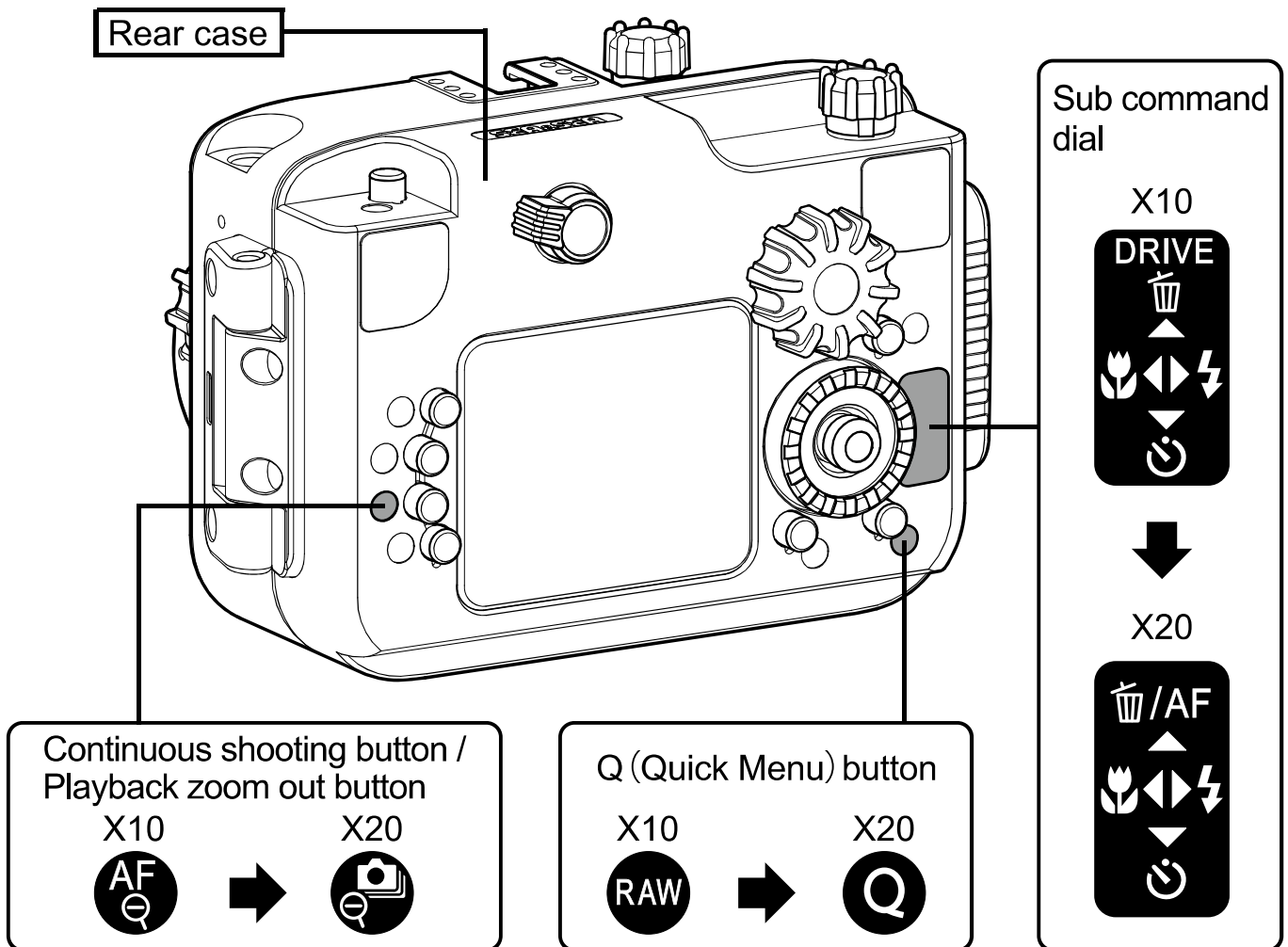

- Above diagram shows only the different in functions on the buttons of the X20 camera.
- All other function buttons on the X20 camera are the same as in the instruction manual.
- Kindly follow instruction manual on the X20 camera for each function buttons.