

Instruction Manual

Thank you for your purchase of a SEA&SEA product. For proper operation of the product and safe handling, please read the following instructions carefully before use. This manual should be retained for future reference.

Safety Precautions

※Failure to heed the precautions listed below could result in serious consequences. To prevent injury or damage to yourself and/or others, please observe the precautions as they contain highly important information related to personal and product safety.

⚠ **WARNING** : Situations that could result in severe injury or death.

⚠ **CAUTION** : Situations that could result in property damage or personal injury.

⚠ **WARNING**

- Keep out of reach of children to prevent accidental ingestion. If swallowed, seek medical advice immediately.

⚠ **CAUTION**

- SEA&SEA's fiber-optic cables are the only recommended cables for this product. Use of other cables may damage the cable and/or this product.
- SEA&SEA SUNPAK Co., Ltd. assumes no liability for compensation of loss of captured images or expenses caused by loss of images, even if you are unable to shoot due to a product defect or malfunction.
- Do not leave the product in places with hot temperatures such as inside of a car or in a car trunk in summer. The heat may deform plastic parts of the product, damaging internal parts and resulting in malfunction.
- SEA&SEA SUNPAK Co., Ltd. will not be responsible for the replacement or compensation for cameras, lenses or those accessories damaged due to your invalid operation.
- If the digital camera housing is damaged, contact the manufacturer of the housing.

Maintenance and Storage

- Do not store the product in wet or high humidity place, to avoid mold, rust, corrosion or malfunction.
- Always rinse this product with fresh water after use and keep dry.
- Do not store the product with naphthalene or camphor mothballs, or in locations such as a laboratory where chemicals are used. This environment can cause mold, rust, corrosion or malfunction.

Identification of Parts

- ① Grommet
- ② Nut
- ③ Strobe Mask (2pcs)
- ④ Tape (2pcs)

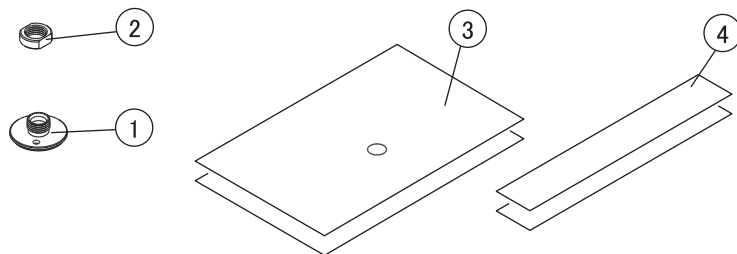

※ Specifications and appearance are subject to change without notice.

How to Use < Attaching to a compact digital camera housing >

- 1** Put the Grommet (①) temporarily on the flash window of the housing to confirm the attaching location for the Strobe Mask. Place the Grommet at the center of the camera's built-in flash.

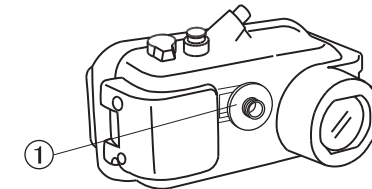

- 2** Cut the Tape (④) into appropriate shapes so that they do not disturb housing operation. Apply the Tapes to the housing to lay the Strobe Mask in place over the flash window. Make sure the Mask completely covers the flash window.

⚠ **CAUTION**

- Remove grease and debris from the surface of the housing to ensure a secure grip on the housing.
- To clean the surface of the housing, refer to the manufacturer's instruction manual.

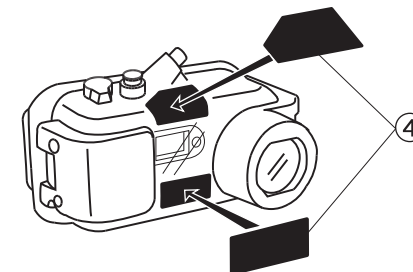

- 3** Fit the hole of the Strobe Mask (③) to the Grommet (①), and cut the Strobe Mask in the appropriate shape to attach to the housing.

⚠ **CAUTION**

- Strobe Mask is two-sided. Check the front (surface) side and reverse (joint) side before cutting.
- First, cut the Strobe Mask slightly larger than the actual shape. Gradually trim the Strobe Mask to the appropriate size.

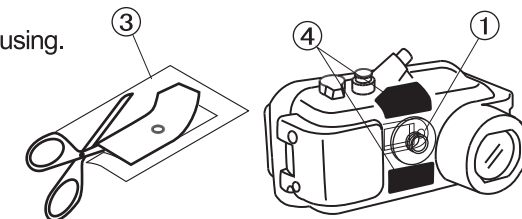

- 4** Insert the Grommet (①) through the hole from the reverse (joint) side of the Strobe Mask (③) as shown.

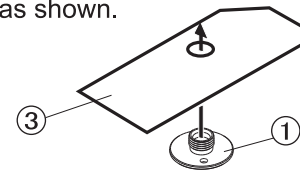

- 5** Fasten the Grommet (①) with the Nut (②). Tighten until secure.

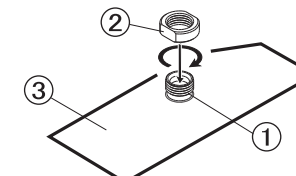

- 6** Attach the Strobe Mask (③) to the Tape (④) on the housing.

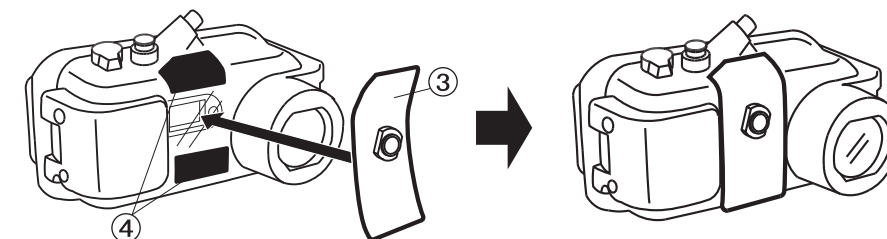

- 7** Insert the connector of the fiber-optic cable into the Grommet (①) and push in until it stops.

⚠ **CAUTION**

- Carefully read the instruction manual for the fiber-optic cable before use.

