

SEA&SEA RIG SYSTEM

Product Manual

Thank you very much for purchasing this C&C product. Please read this user manual carefully before use and ensure you fully understand its contents before operating the product correctly. After reading it, be sure to keep it in a place where you can refer to it at any time.

INFORMATION

You may notice slight variations in color or streaks (weld lines) on the surface of this product; however, these do not affect the product's quality or performance, so please feel free to use it with confidence.

Safety Precautions

Please read these "Safety Precautions" before use and use the product correctly. After reading them, be sure to keep them in a place where you can refer to them at any time.

The precautions listed here contain important information designed to prevent harm or damage to people or the product. Please read and understand this information thoroughly before using the product correctly and safely.

CAUTION Improper handling may result in injury or property damage. It may also compromise the product's quality and reliability.

CAUTION

- Be sure to securely fasten your camera, flash, lights, and accessories, and take care to prevent them from falling or getting lost. Also, do not bend them or apply excessive force. Doing so may result in unexpected injury, damage, or malfunction.
- Be sure to rinse with fresh water after use. (For details, see "Care and Storage Precautions.")
- If you notice any loosening or wobbling of the mounting screws while using this product, retighten them immediately. This could cause the arm, flash, light, or accessories to fall, become damaged, or be lost.
- Avoid installing this product in areas exposed to sand or dust. Sand can get lodged in the screws, causing installation failures.
- Do not subject this product to strong impacts, such as dropping it, swinging it around, jumping into the water from a boat while holding photography equipment, or throwing the equipment into the water. This can result in unexpected injury, damage, or malfunction.
- Do not leave this product in places where it may become extremely hot. In particular, do not leave it in direct sunlight, inside a car during the height of summer, or in a car trunk, as these areas can reach extremely high temperatures.
- Do not store this product in wet or humid locations. This can cause mold, rust, corrosion, or malfunction.
- Do not leave the product wet. If left with water droplets on it, they may leave stains or uneven marks; be sure to wipe them off thoroughly with a soft, non-scratching cloth.
- In the unlikely event that damage or breakage occurs due to the customer's careless handling while using this product, we cannot provide replacements or compensation for cameras, lenses, or other accessories.
- In the unlikely event that you are unable to take photographs due to a malfunction of this product, please understand that we cannot provide compensation for the content of the photographs or any expenses incurred in taking them.
- Please understand that we cannot provide compensation for any errors in the information contained in this manual.

Care and Storage Instructions

- Never use chemicals, cosmetics, petroleum-based solvents (such as paint thinner), or neutral kitchen detergents, as they may cause deformation or damage.
- After use, soak the product thoroughly in fresh water, then rinse it under running water. Move the moving parts while rinsing.
- If you do not soak the product thoroughly in fresh water or simply rinse it under running water, salt residue will remain. When this salt dries, it crystallizes and becomes difficult to dissolve in water. Salt crystals adhering to this product are extremely difficult to remove and may cause rust or corrosion, so be sure to soak it thoroughly in fresh water.
- After washing, thoroughly wipe off any moisture with a dry, soft cloth and let it air dry in the shade.
- Do not use heat-generating devices to force-dry the product, as this may cause deformation or damage.
- When not in use for an extended period, store the product away from high temperatures, high humidity, direct sunlight, and extremely cold environments.
- Do not store this product in areas containing naphthalene or camphor, or in places where chemicals are handled, such as laboratories. This can cause mold, rust, corrosion, or malfunction.
- After use, store the product with all components removed.
- Although this may vary depending on frequency of use and storage conditions, we recommend having the product overhauled (for a fee) approximately once every two years after purchase to maintain its performance.

Instructions for Use

All products listed in this user manual are sold individually. Please feel free to combine them as you see fit, depending on your intended use.

* Please note that specifications and appearance are subject to change without notice.

RS Main Frame

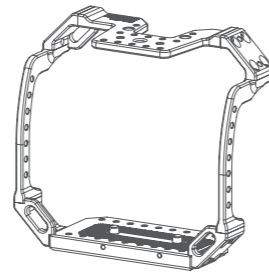

This is the basic frame kit for the system. It can also be used on its own as a grip and tray for an action camera. You can customize your system to your liking by adding various parts.

Model	RS-MF
Color	Black / Silver
Size	W151×H141×D62mm
Weight	240g
Acc.	Hex wrench (M3)

RS Single Grip Set

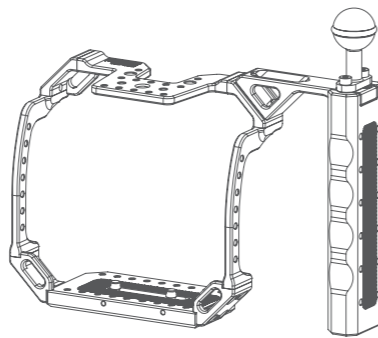

This is a set consisting of the RS Mainframe and the RS Standard Grip. You can add the RS Standard Grip to the right side to build a double-grip configuration.

Model	RS-SGS
Color	Black / Silver
Size	W215×H193×D62mm
Weight	370g
Acc.	Hex wrench (M3) Hex wrench (M4)

Installing the Camera Mounting Screw

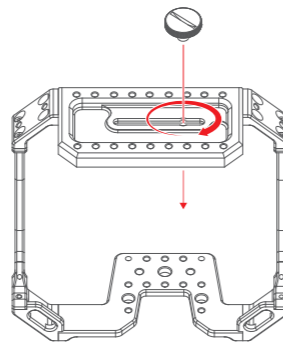

- 1 Screw the camera mounting screw clockwise into the location shown in the diagram on the bottom of the RS mainframe.

• Once the camera mounting screw is screwed in all the way, you can move it slightly to the left or right as needed.

RS Standard Grip

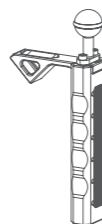

Additional grip parts. By rearranging the bracket components, they can be used on both the left and right sides.

Model	RS-SG
Color	Black / Silver
Size	W85×H193×D38mm
Weight	212g
Acc.	Hex wrench (M4) M4 Bolt (long)×2 M4 Bolt (short)×2

Installing the RS Standard Grip

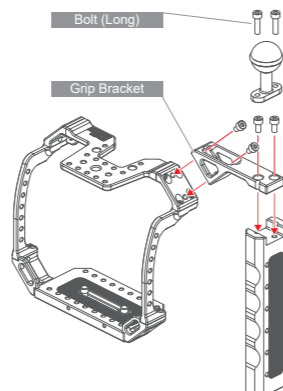

- 1 Secure the grip bracket to the grip with two bolts.

• You can switch the left and right sides by adjusting the orientation of the grip bracket.

- 2 Secure the grip bracket to the RS Main Frame with two bolts.

• Please check to make sure there is no wobble or looseness.

- 3 If necessary, secure the RS Ball Base to the grip top using two long bolts.

• Please check to make sure there is no wobble or looseness.

RS Multi Angle Grip (Left and Right Set)

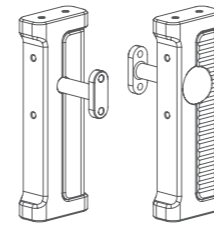

This is a grip set that allows for 360° angle adjustment. It includes a set of two grips, one for the left and one for the right.

Model	RS-MG
Color	Silver
Size	W59×H122×D44mm
Weight	187g
Acc.	Hex wrench (M4) M4 Bolt×2

Installing the RS Multi Angle Grip

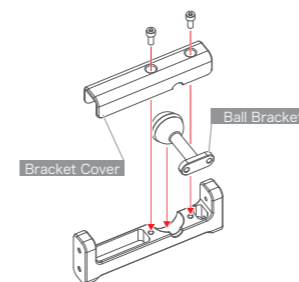

- 1 Clamp the ball bracket between the grip and the bracket cover, and secure it with two bolts.

• Please check to make sure there is no wobble or looseness.

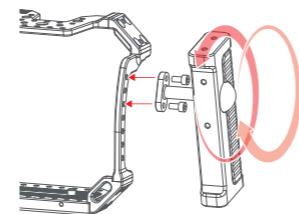

- 2 Secure the RS Multi Angle Grip to the designated location on the RS mainframe using two bolts.

• Please check to make sure there is no wobble or looseness.

- 3 Rotate the grip to adjust the position.

• You can also adjust the angle while underwater.

RS Palm Grip



Since you can maintain your posture using the palm of your hand rather than your fingertips, you can reduce fatigue even during long shooting sessions.

Model	RS-PG
Color	Black
Size	W24×H73×D48mm
Weight	48g
Acc.	Hex wrench (M4) M4 Bolt×2

Installing the RS Palm Grip

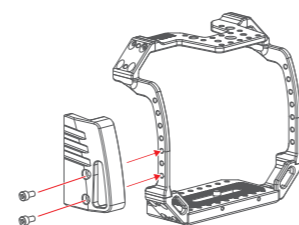

- 1 Secure the RS Palm Grip to the RS main frame using two bolts.

• Please check to make sure there is no wobble or looseness.

RS Ball Base



You can add starting points for extending the lighting arm to various positions.

Model	RS-BB
Color	Black / Silver
Size	W29×H47×D25mm
Weight	33g
Acc.	Hex wrench (M4) M4 Bolt (long)×2 M4 Bolt (short)×2

Installing the RS Ball Base

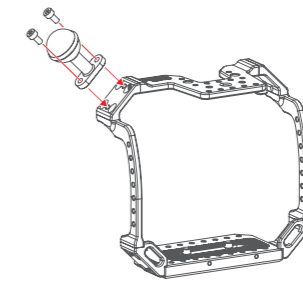

- 1 Secure the RS Ball Base in your desired position using two bolts.

• Please check to make sure there is no wobble or looseness.

The RS Ball Base can be mounted in various positions around the RS main frame—such as on the top of the grip or on the sides—where the screw holes align.

RS Bayonet Mount Base

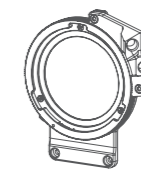

Allows for one-touch attachment and removal of compatible bayonet-mount conversion lenses.

Model	RS-MB
Color	Black
Size	W96×H105×D9mm
Weight	67g
Acc.	Hex wrench (M3) M3 Bolt×2

Installing the RS Bayonet Mount Base

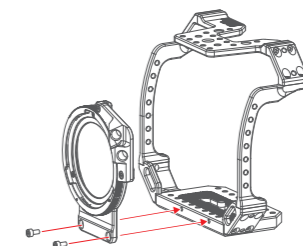

- 1 Secure the RS Bayonet Mount Base to the RS main frame using two bolts.

• Please check to make sure there is no wobble or looseness.

RS Bayonet Lens Holder

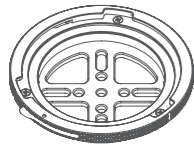

It can securely hold a compatible bayonet-mount conversion lens with a single touch.

Model	RS-BLH
Color	Black
Size	Φ81×17mm
Weight	49g
Acc.	Hex wrench (M4) M4 Bolt×2

Installing the RS Bayonet Lens Holder

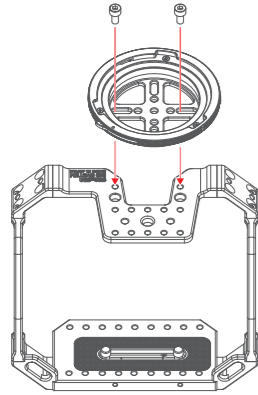

- 1 Secure the RS Bayonet Lens Holder to the RS main frame with two bolts.

- Please check to make sure there is no wobble or looseness.

RS Remote Controller Bracket

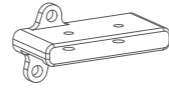

Mount the LX Remote Controller within easy reach so you can adjust the light level while maintaining your shooting posture.

Model	RS-RCB
Color	Black
Size	W24×H50×D27mm
Weight	25g
Acc.	Hex wrench (M4) M4 Bolt×2

Installing the RS Remote Controller Bracket

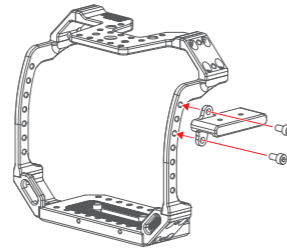

- 1 Secure the RS Remote Controller Bracket to the designated location on the RS main frame using two bolts.

- Please check to make sure there is no wobble or looseness.

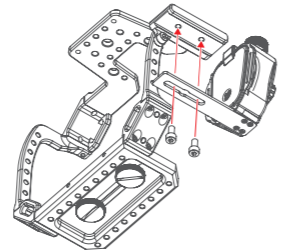

- 2 Secure the LX Remote Controller mount to the RS remote controller bracket using two bolts.

- Please check to make sure there is no wobble or looseness.

RS Shutter Release Lever

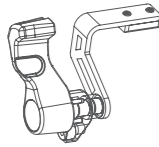

Converts the PT-059's push-down shutter to a pull-back trigger style. This helps prevent accidental half-presses and image blur caused by camera shake, while also reducing fatigue in the right hand.

Model	RS-SRL
Color	Black
Size	W51×H67×D30mm
Weight	26g (w/w 140g)
Acc.	Hex wrench (M4) M4 Bolt×1

Installing the RS Shutter Release Lever

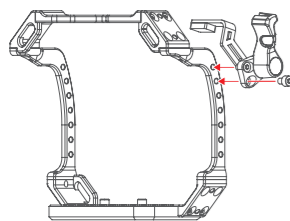

- 1 Secure the RS Shutter Release Lever to the RS main frame with two bolts.

- Please check to make sure there is no wobble or looseness.